

# Cell-PLX™

## EV Battery Interconnect System

### Insulation Layers

- Dielectric strength: 5kV - 20kV
- Materials:
  - **Plastic:** PPA, PC/ABS, Nylon 6, XAREC (*min. 2mm thick*)
  - **Film:** Polyimide, Nomex, Lexan, Mylar, Epoxy (*.127mm - .305mm thick*)

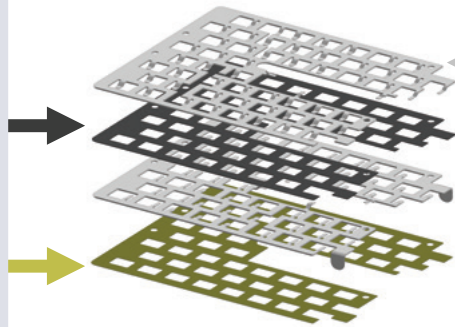

### Aluminum/Copper Busbar

- Coined and formed
- .127mm - 2mm thickness
- Positive and negative interconnects for weld or wire bond attachment
- Single or multi-layer

### Overmolded Lead Frame

- Robust attachment to connect the multi-layer busbar to the cells, with a robust connection to the control board

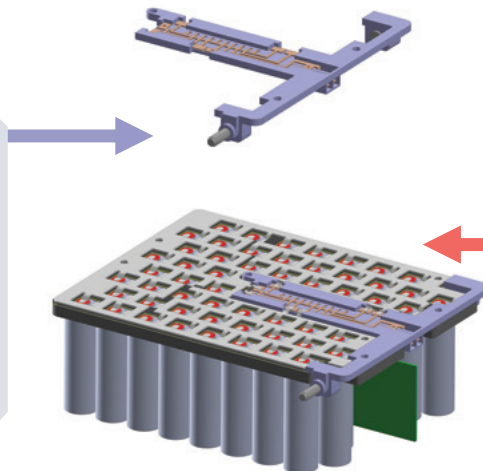

### EV Battery Interconnect System

- For cell attachment to your control board
- Interplex will specifically design to meet your requirements; any number of cells, configurations, and size of packaging is possible

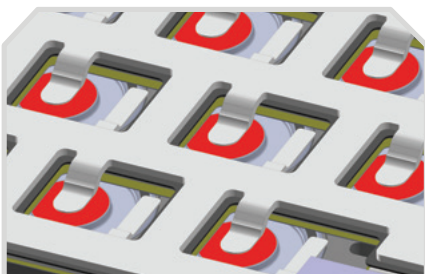

Coined and formed positive and negative cell interconnects

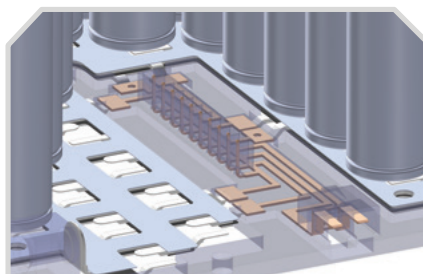

Overmolded lead frame connects multi-layer busbar to male connector

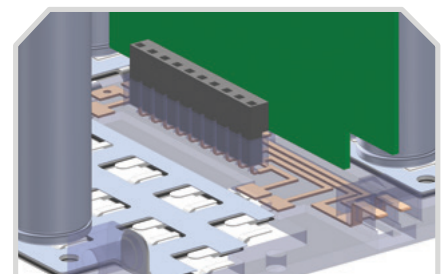

Female receptacle connects control board to overmolded lead frame male connector